

ASSEMBLY INSTRUCTIONS FOR NIMITZ CLASS CARRIER SUPER DETAIL SET

THE NIMITZ CLASS CARRIER SUPER DETAIL SET WAS DESIGNED TO FIT MODERN NIMITZ, EISENHOWER, VINSON, LINCOLN AND ROOSEVELT CARRIERS. THERE ARE ENOUGH FITTINGS TO COMPLETELY OUTFIT ONE MODEL WITH SOME PARTS LEFT OVER. FITTINGS ARE INCLUDED FOR ALMOST ANY ERA OF CARRIER. CHECK REFERENCES FOR PLACEMENT OF ADDITIONAL DETAILS. THE MODEL KITS ARE NOT PERFECT, REQUIRING MODIFICATIONS TO THE SPONSONS AND OTHER AREAS TO BUILD A TRULY ACCURATE MODEL.

THE DETAILS FOR THE AIRCRAFT WHILE VERY SMALL ARE QUITE ACCURATE IN SHAPE AND SIZE. ONCE PAINTED THEY MAKE A REMARKABLE MODEL AND CREATE DRAMATIC SCALE.

A-6 DETAILS - TWO LANDING GEAR DOORS MUST BE BENT TO A MODIFIED "Z". BE SURE TO LEAVE THE METAL TABS CONNECTING THE FRONT GEAR DOORS. BEND THEM TO SHAPE AS SHOWN THEN USE THE TABS AS A SURFACE TO APPLY GLUE.

A-7 DETAILS - FOLLOW THE ILLUSTRATIONS TO ATTACH AND BEND THE LANDING GEAR. THIS IS CRITICAL SINCE THE MAIN GEAR MUST BE EQUAL ON EACH SIDE. PAY CAREFUL ATTENTION! FOLD THE FRONT GEAR AS SHOWN.

SPS-49 RADAR PLATFORM - WE JUST DIDN'T HAVE ROOM ON THE SHEET FOR FOR THIS PLATFORM. HOWEVER, WE HAVE PROVIDED A PATTERN FOR THIS EASY TO MAKE PART. MAKE A COPY OF THE PATTERN. AFTER CAREFULLY CUTTING IT FROM THE SHEET, GLUE IT TO A THIN PIECE OF SHEET STYRENE AND CUT OUT. USE A JEWELERS FILE TO SMOOTH OUT THE EDGES. BEFORE GLUEING, CUT THE THE GUIDE TABS FROM THE TOP. THIS PLATFORM MUST BE USED ANY TIME THE SPS-49 RADAR IS USED.

SPN-43 RADAR - THE SPN-43 IS TO BE PLACED ON PLATFORM P-1.

GOOD LUCK ON YOUR MODELLING PROJECT.

RUSTY WHITE

FLAGSHIP MODELS INC.

NET LOCATION DETAIL

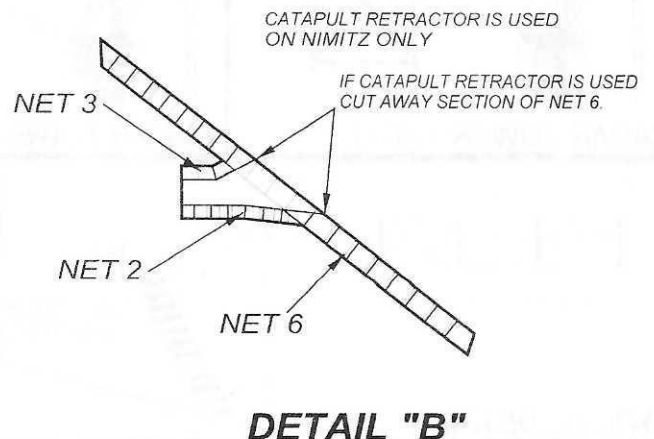
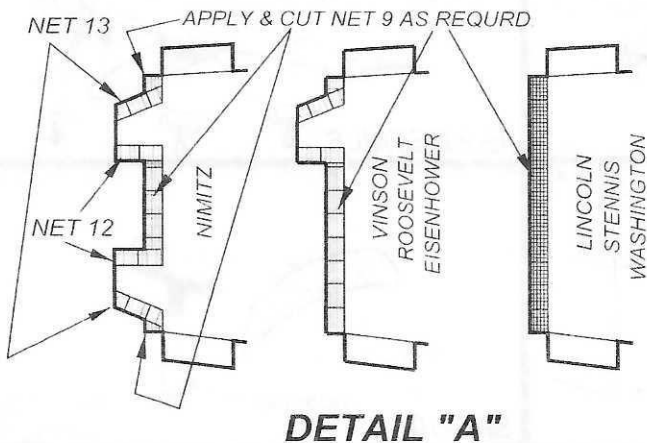
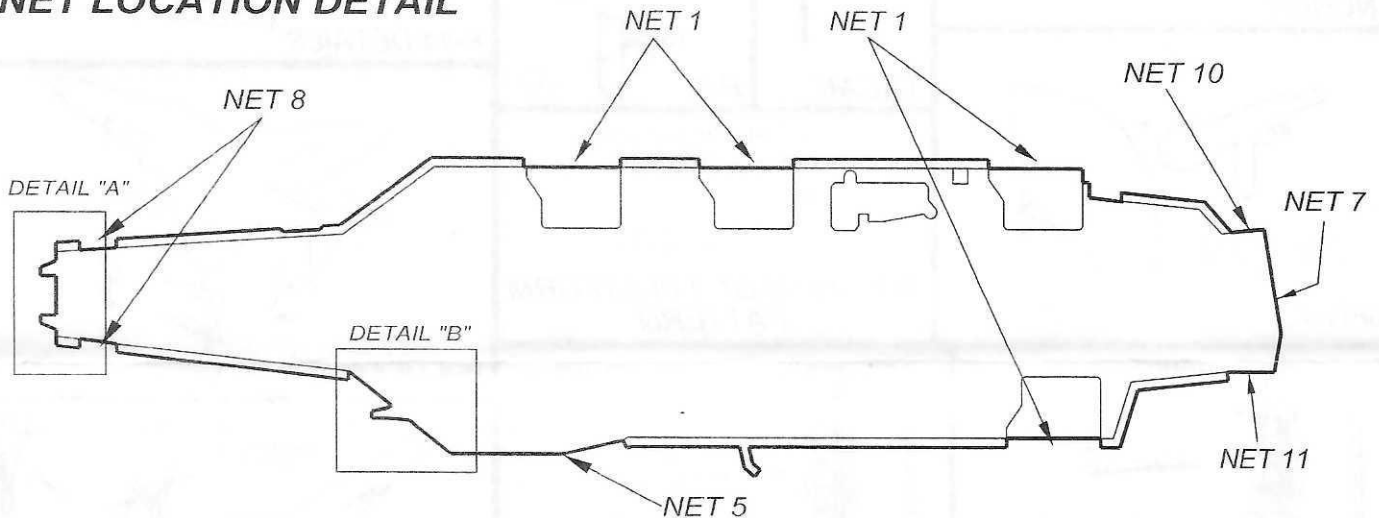

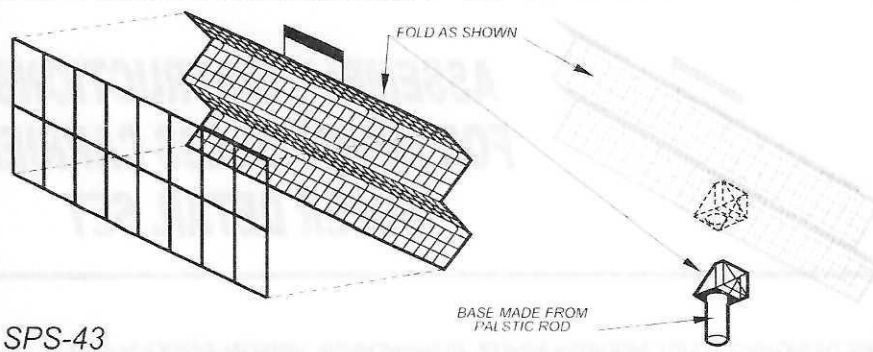

SPS-43

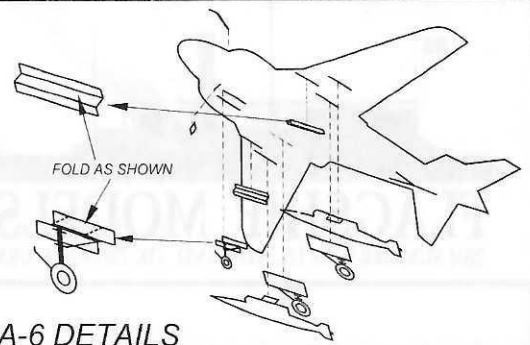

A-6 DETAILS

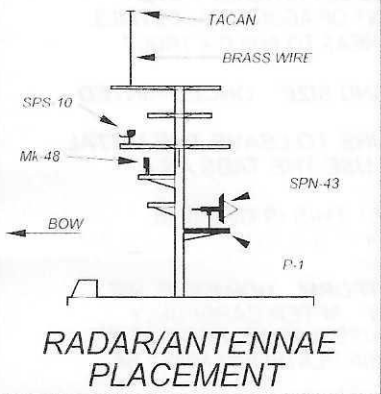

RADAR/ANTENNAE PLACEMENT

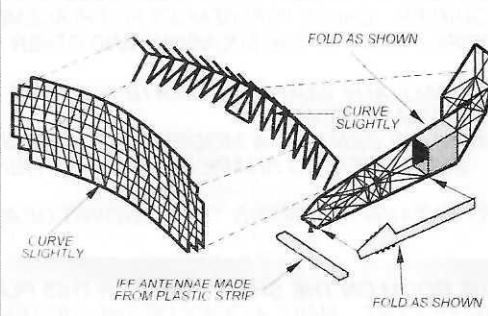

SPS-49

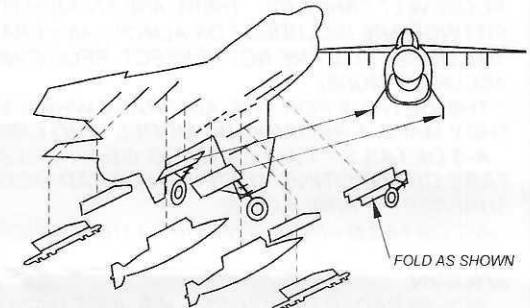

A-7 DETAILS

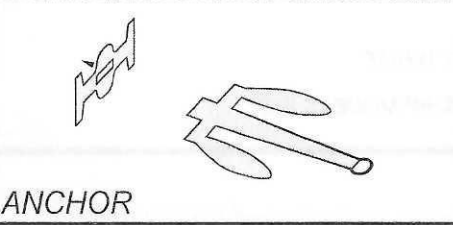

ANCHOR

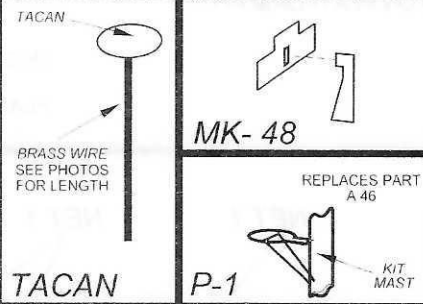

TACAN

MK-48

P-1

KIT MAST

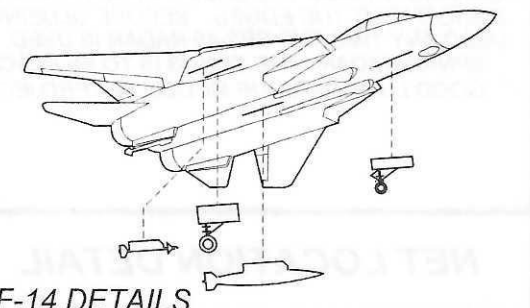

F-14 DETAILS

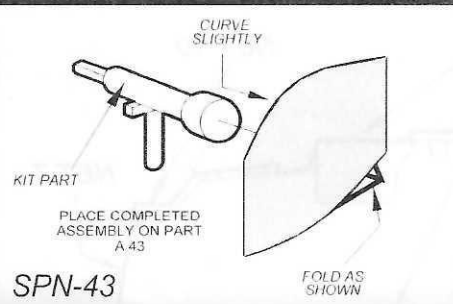

SPN-43

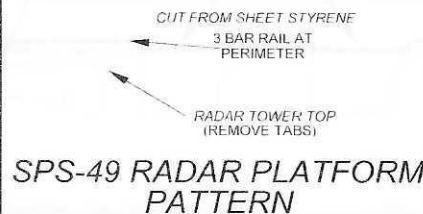

SPS-49 RADAR PLATFORM PATTERN

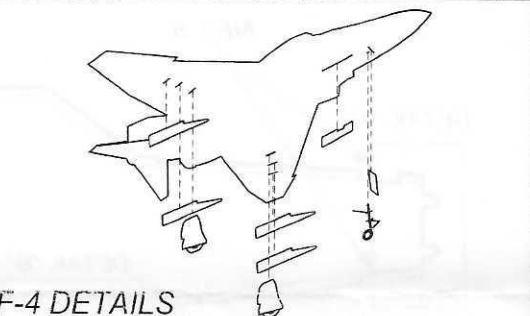

F-4 DETAILS

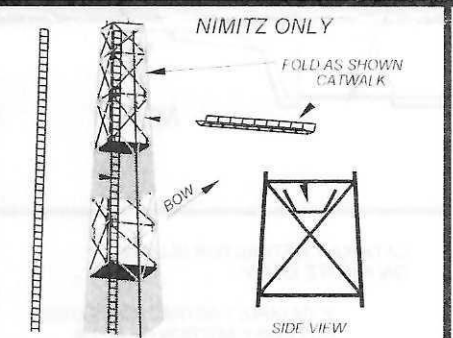

RADAR TOWER 1 (T-1)

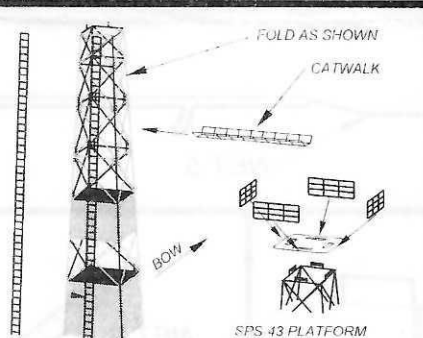

RADAR TOWER 2 (T-2)

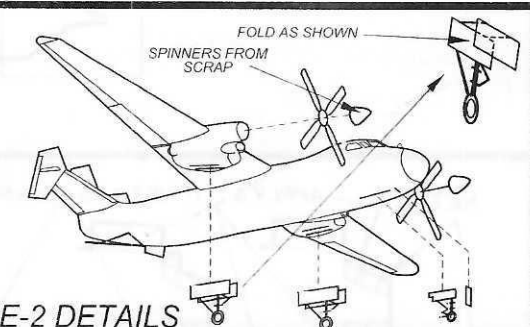

E-2 DETAILS

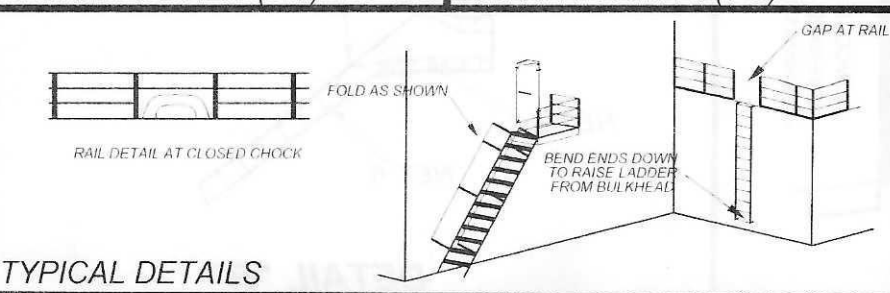

TYPICAL DETAILS

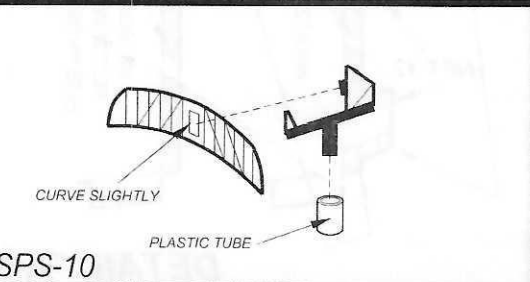

SPS-10